

CAULK WITH CONTINUOUS BEAD OF RTV SILICONE SEALANT BETWEEN REAR HOLES AND BACK OF FRAME (ALL 4 SIDES) FOR SEAL BETWEEN FRAMES AND BETWEEN FRAMES AND PLENUM

#10-32 X 1/2 TRUSS HEAD MACHINE SCREW OR COMPARABLE RIVET.

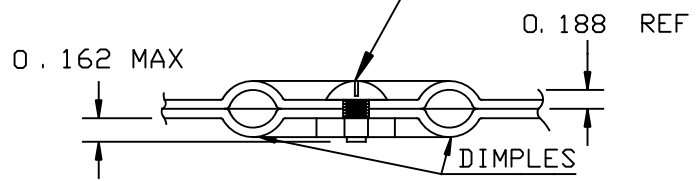

TOP AND BOTTOM VIEW OF TYPICAL FASTENER BETWEEN FRAMES

NOTES:

1. FOR PROPER SEALING AND STRENGTH, INSTALL FASTENERS IN ALL THE MOUNTING HOLES PROVIDED IN THE FRAMES.
2. STIFFENER BARS
 - A) BANKS 1 THRU 4 FRAMES HIGH: NO STIFFENER BARS REQUIRED.
 - B) BANKS 5 OR 6 FRAMES HIGH: INSTALL A 3/16" THK X 4" WIDE CONTINUOUS VERTICAL STEEL BAR BETWEEN EVERY OTHER COLUMN OF FRAMES.
 - C) BANKS 7 OR 8 FRAMES HIGH: INSTALL A 3/16" THK X 4" WIDE CONTINUOUS VERTICAL STEEL BAR BETWEEN EVERY COLUMN OF FRAMES.
 - D) FOR BANKS OVER 8 FRAMES HIGH OR FILTER RESISTANCE OVER 4 IN. W. C. , CONSULT FACTORY.

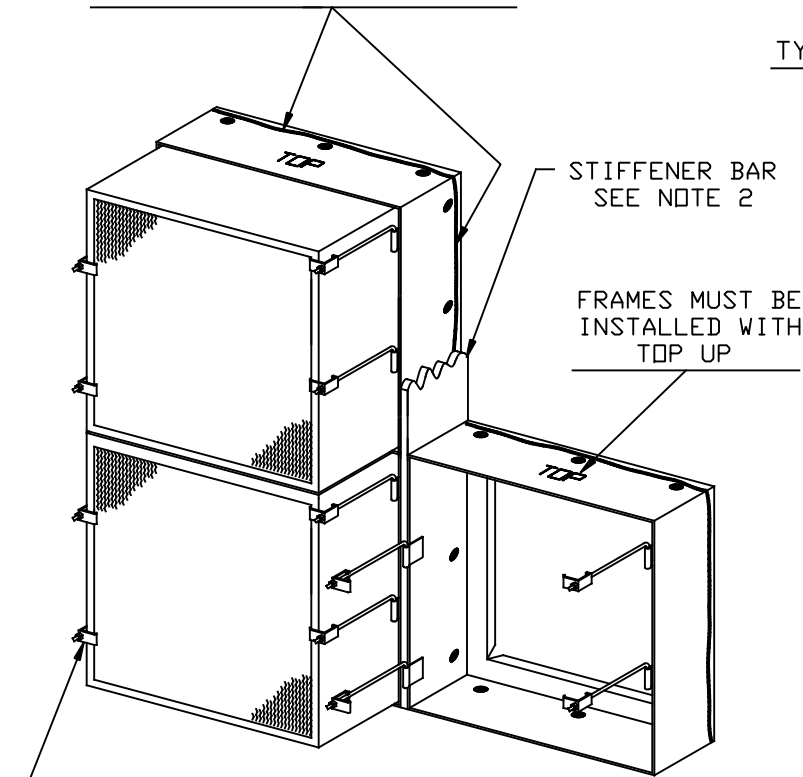

#10-32 X 1/2 TRUSS HEAD MACHINE SCREW OR COMPARABLE RIVET.

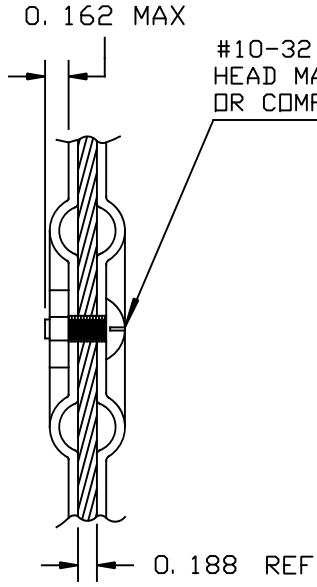

SIDE VIEW OF TYPICAL FASTENER BETWEEN SIDES OF FRAMES-WITH STIFFENER BAR

F	11/29/07	REVISED	14955-AT	SMA	-	-
A	2/17/94	FIRST ISSUE	10413-N	SJ	GM	ES
REV.	DATE	DESCRIPTION	EWD	DFT	CK	APP



©Camfil <http://www.camfil.com>

DESCRIPTION
MAGNA-FRAME II INSTL. INST.
GASKET-SEAL ABSOLUTE FILTERS

SHEET	DRAWING NUMBER:	REV.
1 OF 1	120652	F